

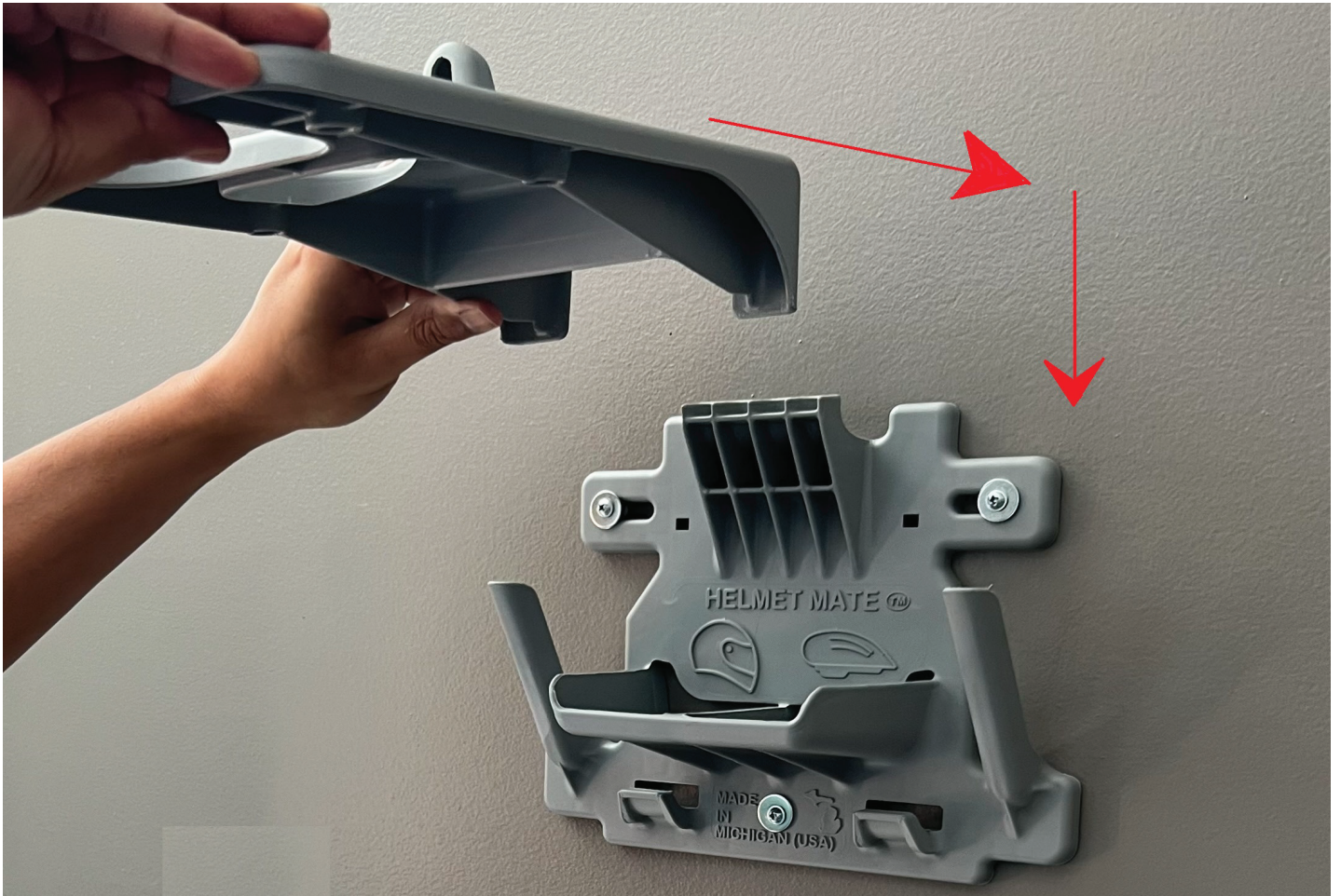

YASH LIGHT
INDUSTRIES
LLC

Making Life Better-Together



Helmet mate™
has two components,
'Back plate' and 'Platform'

MADE IN USA 
#HELMETMATE

★ ★ ★
BROCHURE

INSTALLATION INSTRUCTION:-

Contents : 1 Back plate, 1 Platform

Complimentary hardware (Included): 3 screws, 6drywall anchors, 3washers

- Helmet mate™ * has two components, 'Back plate' and 'Platform'. Place 'Back plate' against continuous, flat and sturdy wall (2/3 inch thick) and mark area to drill holes
- Use ¼" drill three holes in markings
- Gently hammer in the drywall anchors (supplied) into the holes
- Align the 'Back plate' on wall and then insert screw and washer through holes and screw in to the wall anchors, (tip: don't use motorized screw driver, hand screw in)
- Once you make sure the 'Back plate' is tightened into wall, then insert 'Platform' from top as shown in final assembly drawing below
- Extra anchors are provided if can you want to move the mount to new location for one more time
- Check more details on www.helmetmatebuy.com

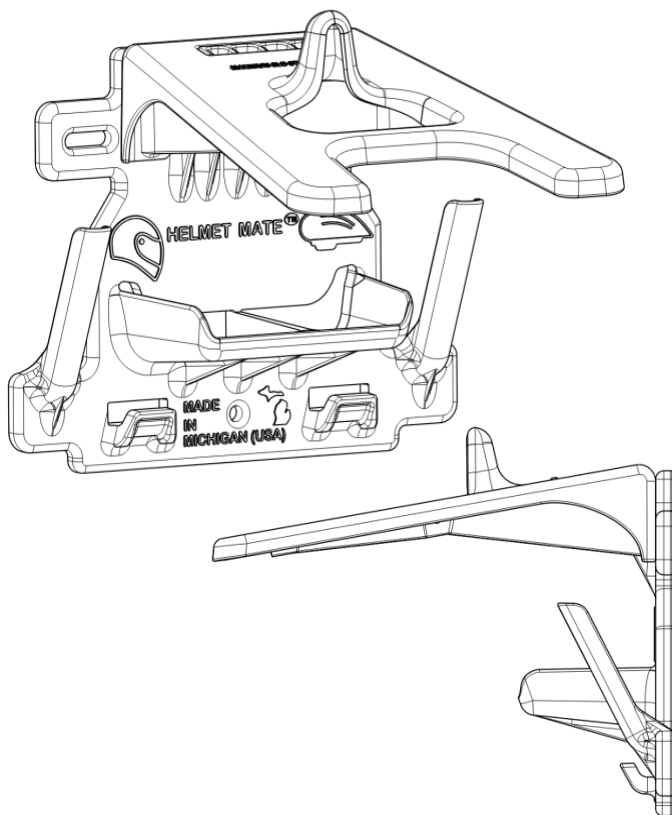

Design patent #29816043,
TradeMark #97060452

This product is designed to attach to drywall or board walls using hardware provided with this product, you however based on your knowledge/ experience and expertise may use different hardware, however product may not perform as intended and you may get different result than product design, warranty on product assumes properly attaching product to wall, and does not include that of the complimentary hardware or voids if failed to secure product on wall or issue with wall integrity or there of any kind

THANK YOU !

WARNINGS :

- This product is meant for indoor use only. Garage use is ok if garage temperature stay between 100°F and 35°F, referred as "operating temperature",
- This product is design to carry max 6LB load on top shelf (typical helmet weight) of static load, static load means you put helmet normal fashion, slowly, please don't drop or throw or 'dunk' helmet on it, as this may break holding mechanism
- This product should be mounted in a space which will not affect your normal living activity (moving around, playing games etc) or it may interfere in your personal space while running or moving around it and cause serious injury, also it should not be hanging above any items, as if product or items its holding drops it shouldn't damage items below it.
- Violating these guidelines may void warranty and/or claims

Contact Us



Address

Rochester Hills, Michigan



Phone

+1 (248) 495-9067